

Vacuum Technologies
A Unit of ASCO POMPE

LIQUID RING VACUUM PUMP Model AVM 26

PERFORMANCE FEATURES

- Vary port valve design for optimum efficiency across all inlet pressures.
- Near-isothermal compression to safely handle any thermally sensitive gas.
- Right choice for any wet process.
- High efficiency IE3 motor for EU market
- [CE] TR CU 010/2011 certification.
- Motor option for US & Canada market (NEMA-CSA).

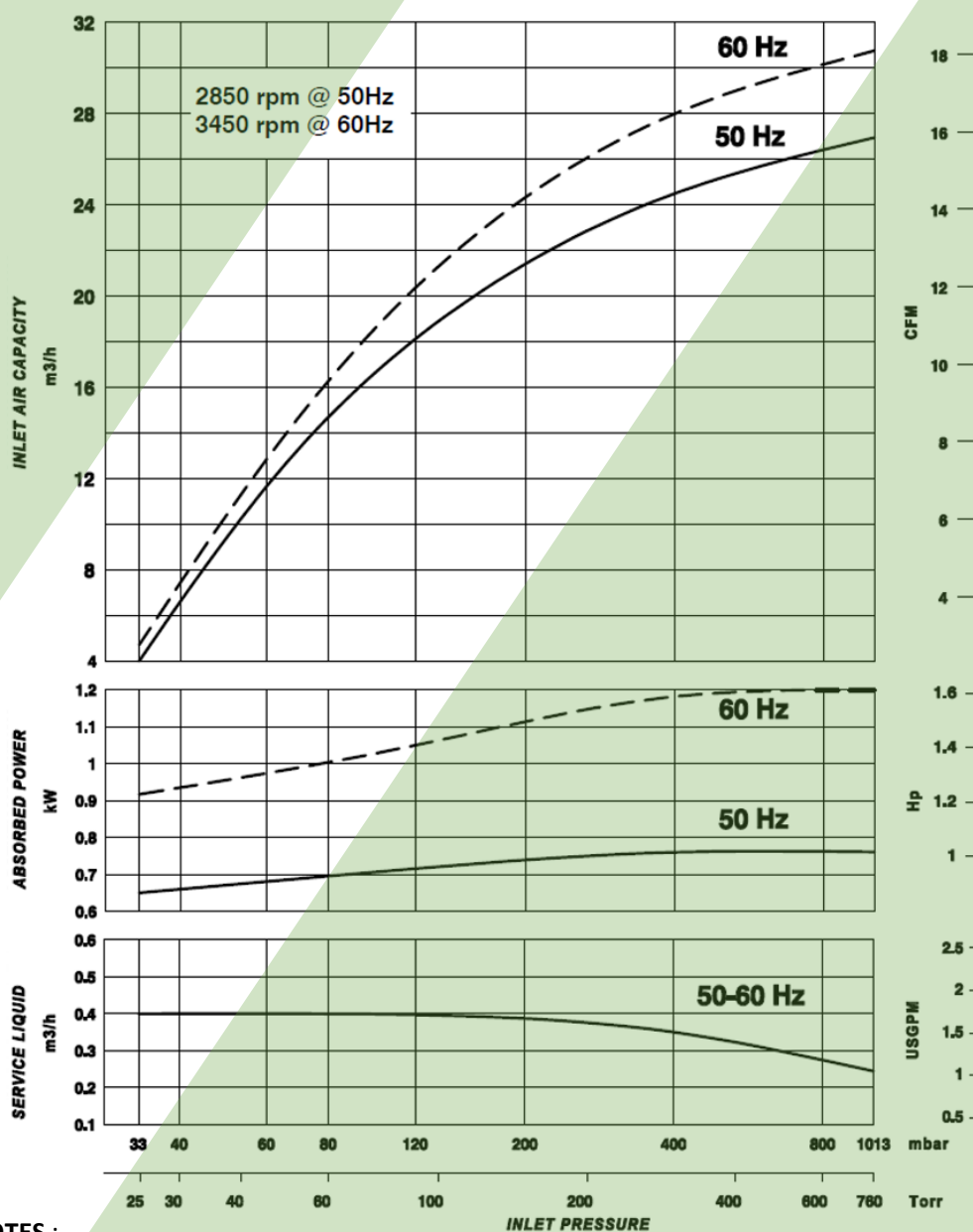

NOTES :

The given data are referred to dry air at the temperature of 20°C, at the atmospheric discharge pressure (1013 mbar), and of supply of service water at 15°C temperature. Performances tolerance $\pm 10\%$.

Product specifications and data are subject to change without notice.

Performance test in compliance with PNEUROP 6612

LIQUID RING VACUUM PUMP

Model AVM 26



APPLICATIONS

- Vacuum industrial processing
- Sterilization
- Extrusion
- Degassing
- Evaporation and distillation
- Priming
- Vacuum sewage
- Bottling
- Depoultry
- Fish farming

FEATURES

AVM 26 is a simple, compact and reliable liquid ring pump capable to handle almost any gas mixture including vapors in vacuum or overpressure. The operating principle combined to its accurate design allow for severe duty with high tolerance of liquid carry over. The wide range of suction pressure (down to 33 mbar abs) makes the AVM series versatile and suitable for many industrial applications and more. The stainless-steel port plate and impeller are designed and manufactured with accurate process to reach outstanding and steady performance.

The low operating speed associated with the robust and simplified construction grant long service life with minimal maintenance. AVM26 is available in standard version or full stainless-steel AISI 316 (wetted parts). Other material options, on request.

MATERIALS OF CONSTRUCTION

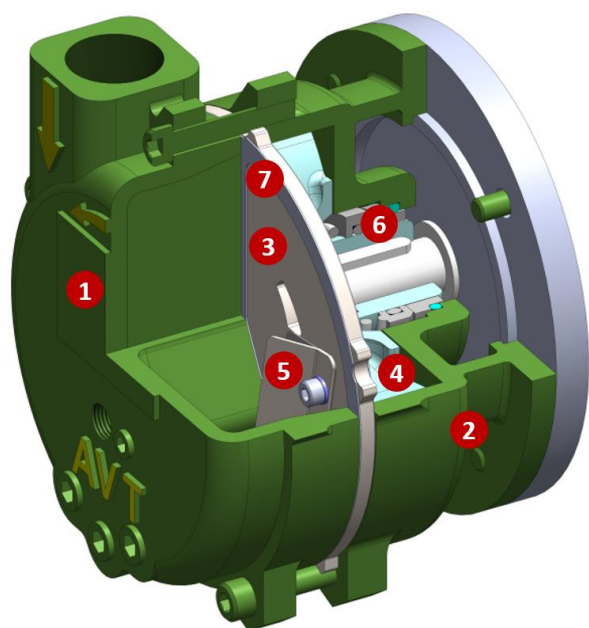

#	PART	CS	SS
1	Suction and discharge casing	CAST IRON (ASTM A278 CL.250)	SS 316 (ASTM A351-CF8M)
2	Housing	CAST IRON (ASTM A278 CL.250)	SS 316 (ASTM A351-CF8M)
3	Port plate	SS 316 (ASTM A240)	SS 316 (ASTM A240)
4	Impeller	SS 316 (ASTM A351-CF8M)	SS 316 (ASTM A351-CF8M)
5	Vary port valve	PTFE	PTFE
6	Mechanical seal	CARBON/SIC/ VITON/SS316	CARBON/SIC/ FEP/SS316
7	Gasket	ARAMIDIC FIBER	ARAMIDIC FIBER



Model AVM 26

LIQUID RING VACUUM PUMP

2D DRAWING

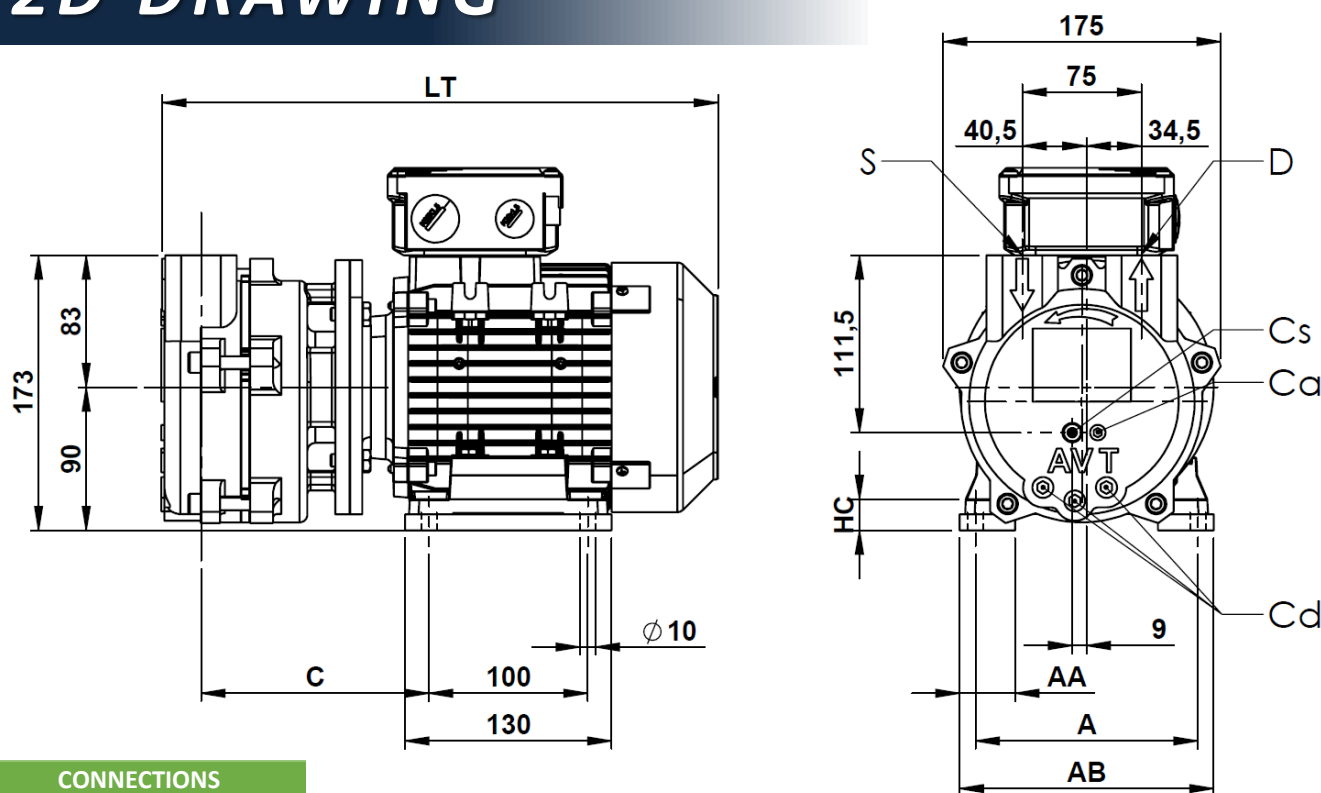

CONNECTIONS

S	G 1"	Suction
D	G 1"	Discharge
Cs	G 1/4"	Service liquid
Cd	G 1/4"	Pump drain
Ca	G 1/8"	Anti-cavitation

Dimensions [mm]

PUMP	kW	Hz	IEC	RPM	Weight [Kg]	A	AA	AB	C	HC	LT
AVM 26-50	0,75	50	80	2850	18	125	35	152	143,5	20	350
AVM 26-60	1,5	60	90S	3450	25	140	37	170	159,5	11	396

TECHNICAL SPECIFICATIONS

	AVM 26-50	AVM 26-60
Nominal capacity	27 m ³ /h	31 m ³ /h
Ultimate pressure	33 mbara	33 mbara
Dry weight	18 kg	25 kg
Max gas temperature	120°C	120°C
Max liquid temperature	50°C	50°C
Casing design pressure	3 barg	3 barg

	AVM 26-50	AVM 26-60
Noise level	72 dBA	72 dBA
Motor power	0,75 kW	1,5 kW
Motor speed	2850 rpm	3450 rpm
Motor type	TEFC	TEFC
Motor efficiency	IE3	IE3
Volt./Ph/Frequency	230-400V/ 3/50Hz	277-480V/ 3/60Hz

SPARE PARTS AVAILABLE

LIQUID RING VACUUM PUMP Model AVM 26

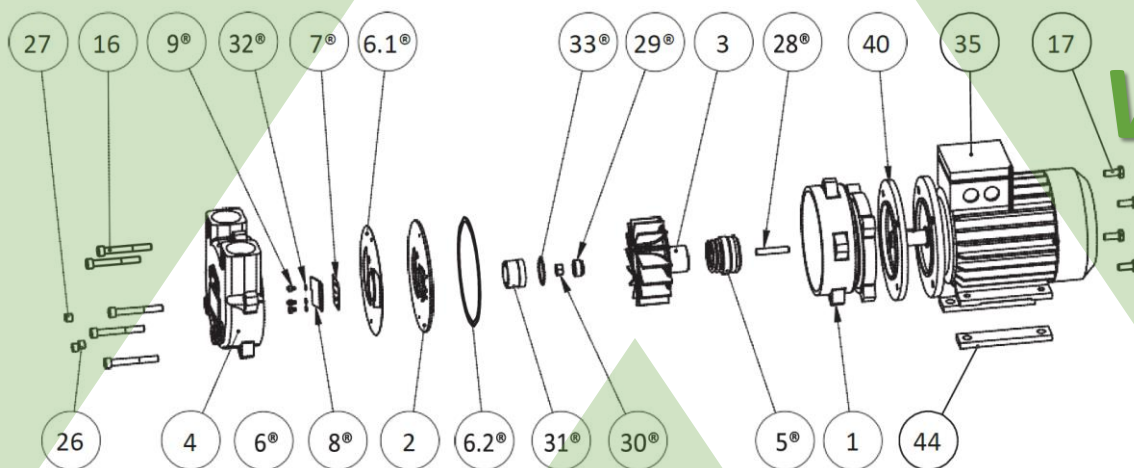

Pos.	Description	Q.ty
1	Casing	1
2	Port plate	1
3	Impeller	1
4	Suction/discharge casing	1
5 [®]	Mechanical seal	1
6.1 [®]	Suction/discharge casing-port plate gasket	1
6.2 [®]	Casing port plate gasket	1
7 [®]	Vari-port valve	1
8 [®]	Valve plate	1
9 [®]	Screw	2
16	Screw	5
17	Screw	4
26	Plug	3
27	Plug	1

Pos.	Description	Q.ty
28 [®]	Stud	1
29 [®]	Adjusting nut	1
30 [®]	Nut	1
31 [®]	Impeller nut	1
32 [®]	Washer	2
33 [®]	O-Ring	1
35	Electric motor	1
40 ^{**}	Motor adapting flange	1
44 ^{***}	Motor foot spacer	2

^{**} Only for AVM 26 60Hz

^{***} Only for AVM 26 50Hz

[®] Repair kit part

OPERATION MODES

Once-through

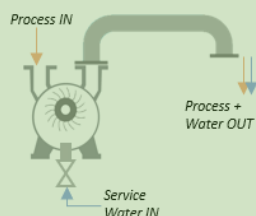

Partial Recirculation

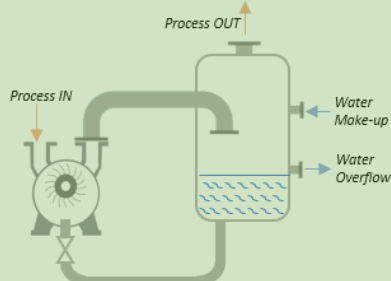

Total Recirculation

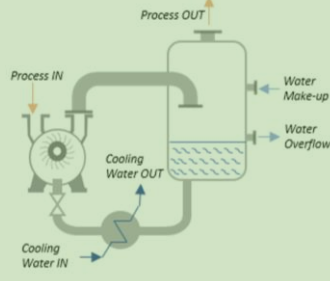

Hybrid

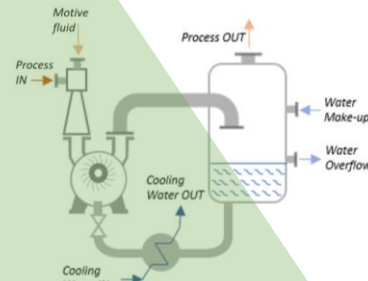

Asco Vacuum Technologies

Asco Pompe S.r.l.

Via Silvio Pellico, 6/8

20089 Rozzano (MI) – Italy

Phone: +39 02 892571

Fax: +39 02 89257201

Mail: info@ascovacuum.com

www.ascovacuum.com